

MAG505R

5-Zone Remote Paging Station



Description

The MAG505R 5-Zone Remote Paging Station is designed for use with professional public address systems. It features a high-sensitivity condenser microphone with a cardioid pickup pattern for clear and focused voice transmission.

Equipped with zone status indicators, the unit provides real-time visual feedback of system operation across multiple zones. It supports flexible connectivity through RJ45, RS485, and 3.5mm stereo/RCA interfaces, ensuring compatibility with a wide range of PA system architectures.

Features

- High-sensitivity condenser microphone for clear voice pickup.
- Cardioid polar pattern for enhanced background noise rejection.
- LED signal indicators for real-time zone status monitoring.
- Supports 5-zone selection plus all-zone paging function.
- 1 auxiliary audio input for external signal integration.
- Independent level control for AUX input, microphone, and chime functions.
- RJ45 network port for connection with the main control host.
- RS485 communication interface for extended system integration.
- 3.5mm stereo and RCA audio interface support.
- Powered by DC24V low-voltage power supply.

Specifications

Model	MAG505R
Power Supply	24VDC, 500mA
MAX. Connection Length	500m
Microphone Type	Condenser microphone
Polar Pattern	Cardioid
Connectors	RJ45, 24VDC power jack, 3.5mm stereo RCA
Frequency Response	-3dB 150Hz-22kHz
Input Level MIC	-46dBV, Aux: -10dBV
Output Impedance	Balanced 600 Ohms
Input Impedance MIC	600 Ohms, AUX: 50k Ohms
Output Level	10dBV
S/N Ratio	-60dB
Interface	RS-485
Dimensions	460mm×140mm×115mm
Weight	670g

Front / Rear Panel

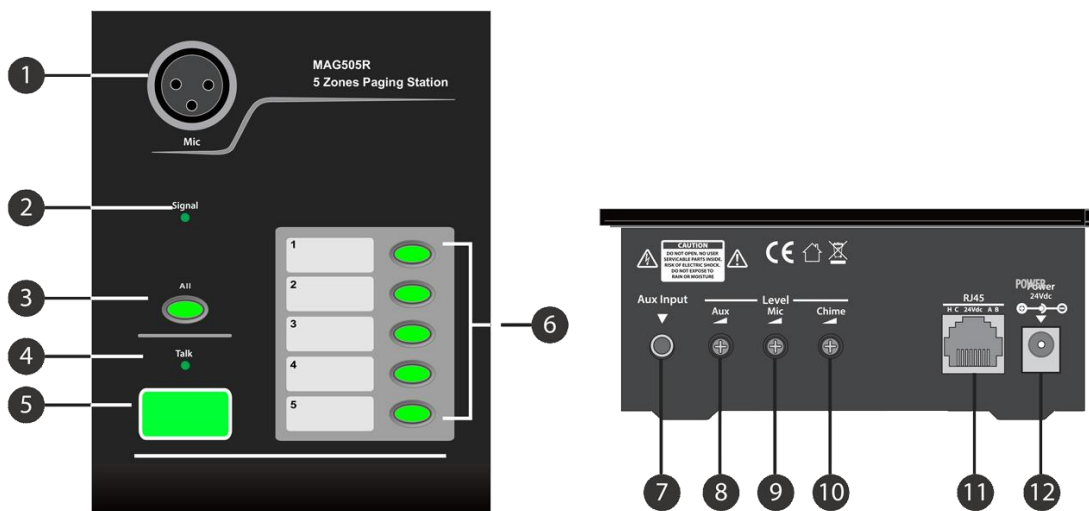

1. Microphone connector
2. Signal LED
3. All button
4. Talk indication
5. Talk button
6. Zone selector

7. AUX input
8. AUX level control
9. Microphone level control
10. Chime volume
11. RJ45 port
12. Power connector